



# *Introducing* **ESP-BAT-BT**



# ESP-BAT-BT NEW

Bluetooth® Battery-Operated Controller

**Out with the old, in with the new.**

Replacing the TBOS-BT-LT to Bring You:

- Less Site Visits
- Greater Visibility
- Enhanced Control
- Superior User Experience

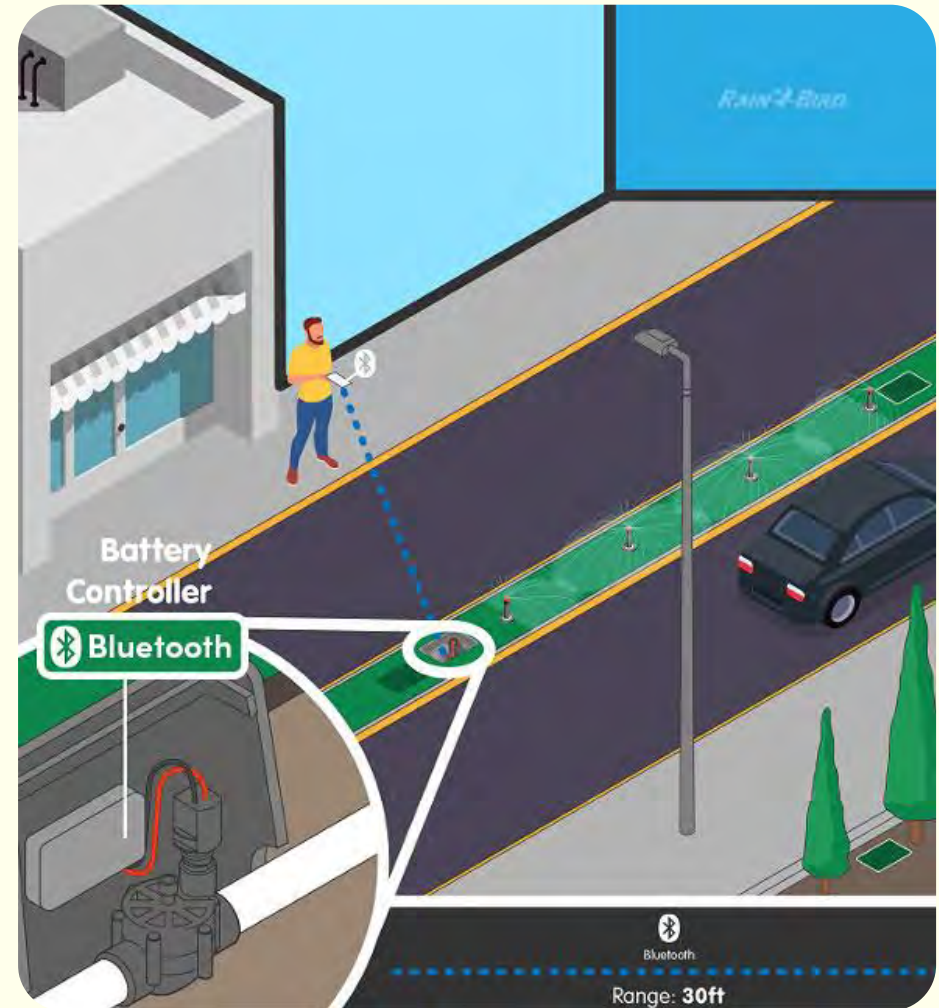

# Convenient Features

*That Save Time and Make Your Job Easier*



## Longer Battery Life

AA batteries provide up to 5 years of operation



## Last Known Status

Easily reference controller status (Auto, Off Rain Delay, etc.)



## Search & Filter Functionality

More flexibility from the home screen



## Advanced Mapping

Access commonly used app features from satellite or map view



## Offline Mode

View and make schedule changes even when out of Bluetooth range



## Monthly Seasonal Adjust

Program run time values up to a year in advance



## Rain Delay

Delay up to 14 days then auto-resume



## Calendar Days Off and No-Water Days

Specify up to 15 days per year and exclude certain days of the week from irrigation



## Station Health and Wire Test

Get proactive insight on system health



## Controller Sharing

Give your team visibility into the same controller information, updates and settings



## Brand New App Interface

Streamlined navigation and controls for improved user experience



## Additional Image Options

Greater personalization and convenience

# BAT-BT

(TBOS Replacement)

**Bluetooth Range:** 30–50 ft. (9.144–15.24 m)  
when installed in a plastic valve box

**Station Count:** 1, 2, 4 and 6

**Start Times:** 8

**Dedicated Master Valve Wire:** Yes

**Programs:** 4 (A, B, C, D)

**Seconds-Based Irrigation:** 7 seconds to 18 hours

**Interstation Delay**

**Cycle & Soak™**

**Battery:**

**Lifespan:** Up to 5 years

**Design:** Wireless

**Type:** 4 AA (LR6) Batteries

NEW!

New 2024



Bluetooth Battery-Operated Controller

New and Notable

# Dedicated Master Valve Wire

**All models come with a dedicated M.V. wire.**

Should a master valve be installed, relinquishing a station wire is not required.



INDUSTRY'S BEST!

## 5-Year Battery Life

The first manufacturer to use AA batteries instead of 9V batteries for:

- ✓ Extended lifespan
- ✓ Less site visits
- ✓ Lower costs
- ✓ Reduced waste

### 5-Year Cost of Battery Maintenance: 9V vs AA

Power Source	(1) 9V Battery	(4) AA Batteries
Avg. Battery Price	\$3.74 each	\$0.77 each
# of Replacements Needed	5	1
# of Site Visits Needed	5	1
<b>Total Cost of Battery Maintenance*</b>	<b>\$18.70 + 5 site visits</b>	<b>\$3.08 + 1 site visit</b>

\*Battery life is dependent on irrigation schedule. Prices shown are USD.

New and Notable

# Wireless Battery Pack

**NEW!** Battery changes have never been easier.

Simply unscrew the cap and pull the wireless battery tray out to remove and replace batteries in a matter of seconds.

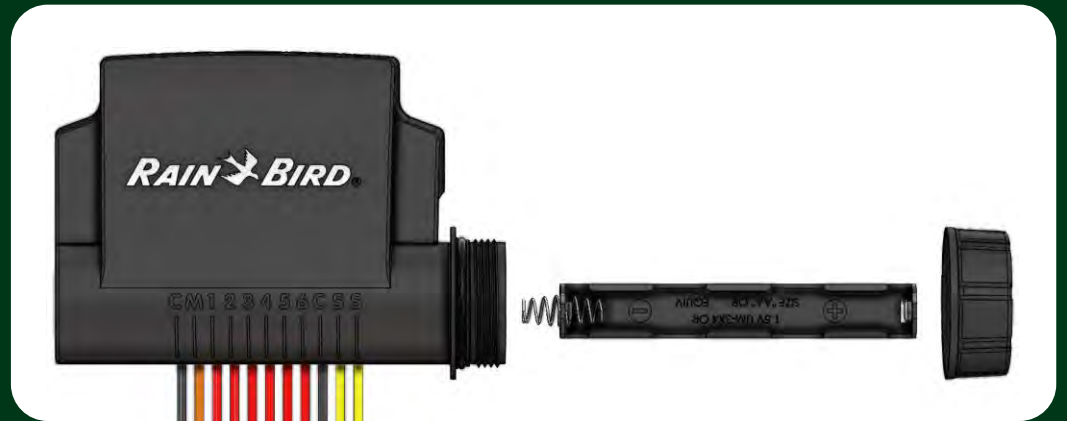

New and Notable

# Waterproof Design

**NEW!** Rugged and rigorously tested

The BAT is IP68 rated and built to withstand the harshest conditions. The waterproof controller case and sealed battery cap protect against dirt, dust and water...even if the valve box floods frequently.

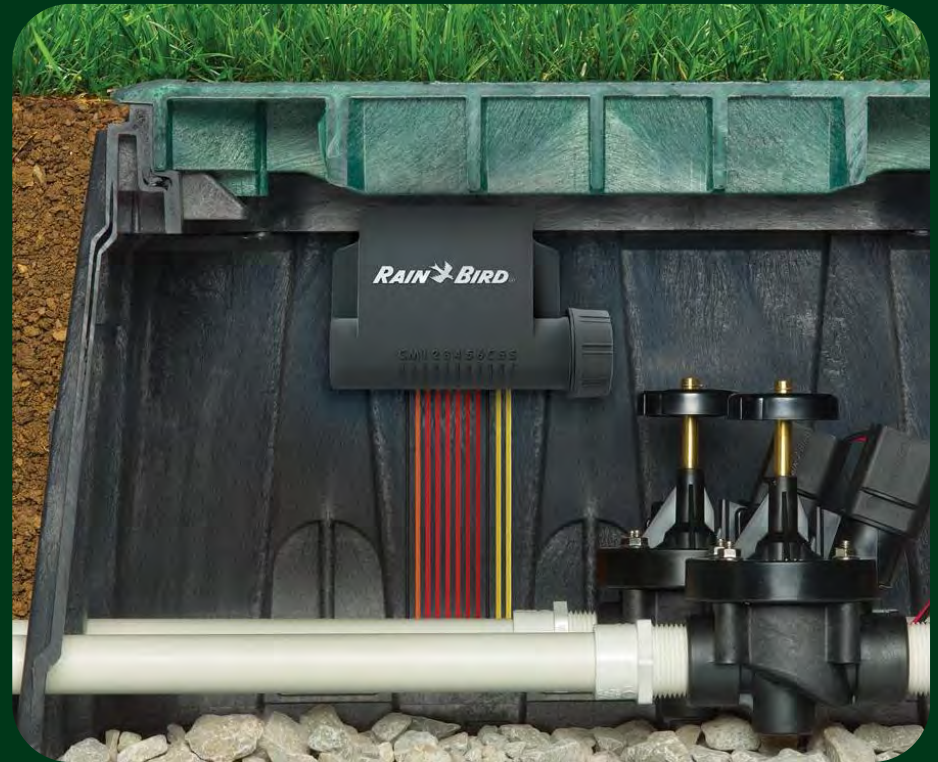



New and Notable

# 3 Simple Mounting Options

Make the most of the **industry's longest Bluetooth range** with proper mounting at the **top of the valve box**.

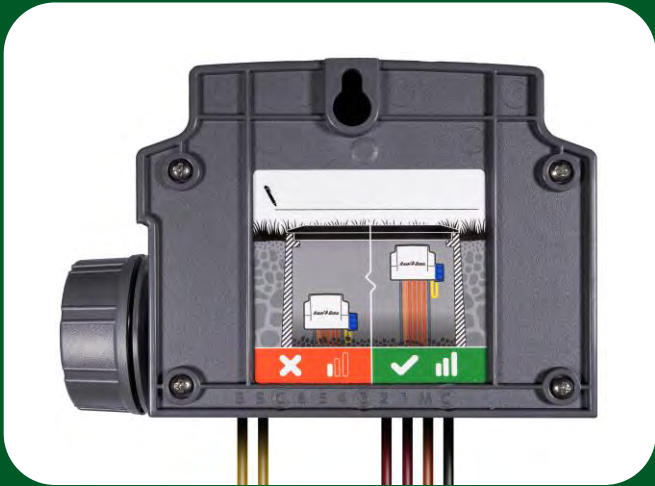

## Mounting Option 1: Mounting Peg (Tool-less Install)

Back plate hanger can be mounted to any VB-STD rectangular valve box with a factory-integrated mounting peg.

## Mounting Option 2: Cable Tie (Tool-less Install)

Using the provided cable tie, hang from the locking ring of the valve box (if not in use).

## Mounting Option 3: Screw Mount

Back plate hanger can be mounted to a single user-installed screw.

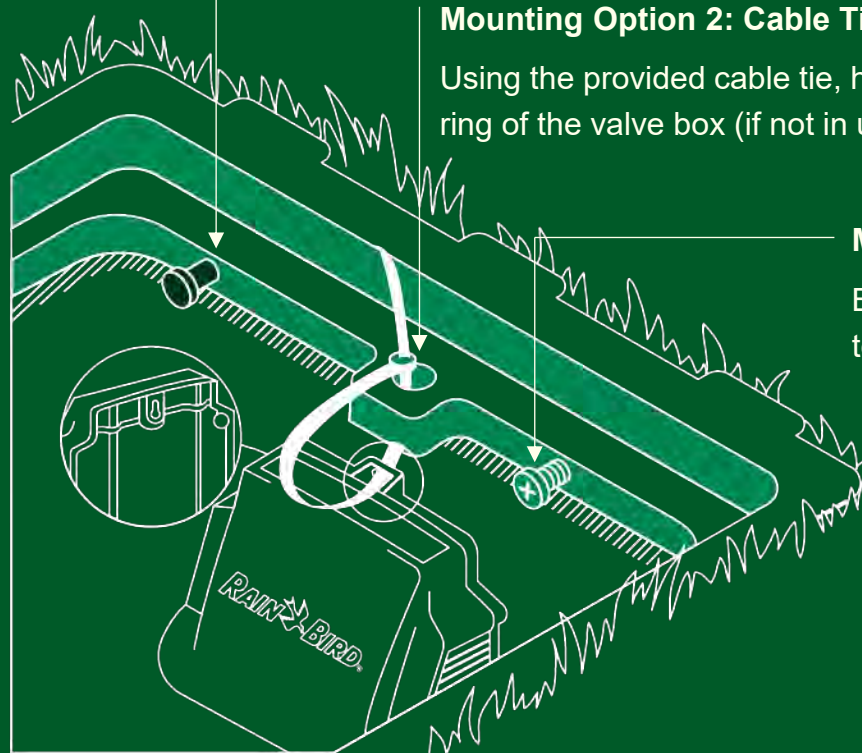

New and Notable

# Guided Setup Wizard

NEW!

**Setup process is as easy as 1-2-3.**

Follow comprehensive, step-by-step instructions in the app. With our scan-to-connect feature and manufacturer-supplied customer label, we make it easy to set up multiple controllers in your office and deploy staff to quickly install in the field.

January 2024

Rain Bird Corporation



10

# Establish Connections

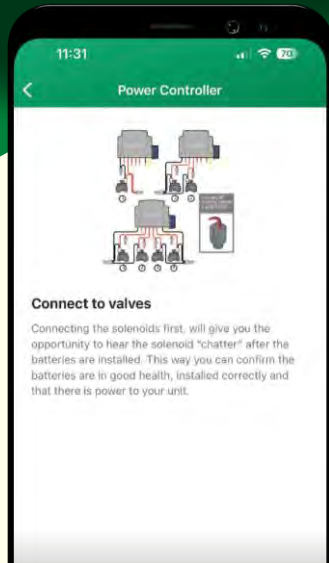

Wire the BAT to solenoids

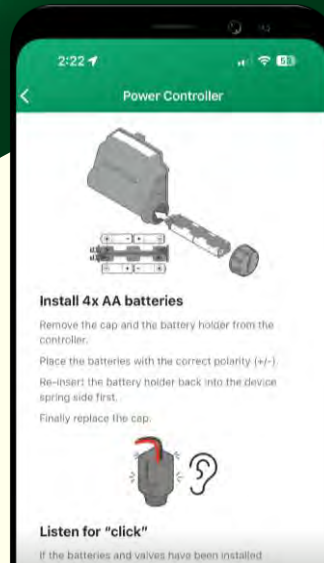

Install batteries and listen for the "chatter"

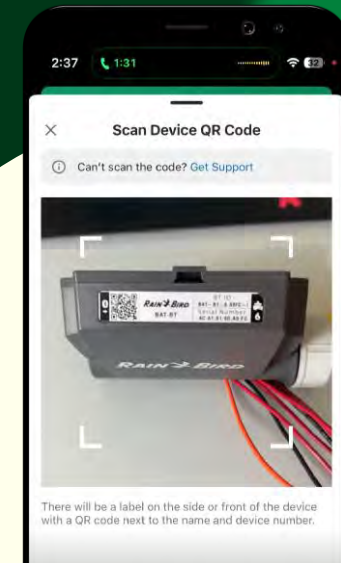

Scan the BAT QR code to pair with Bluetooth

# Optimize Controller

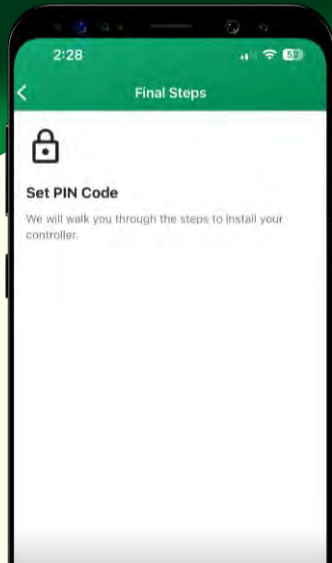

Set PIN code

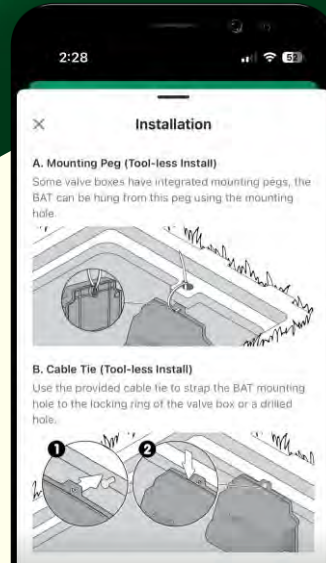

Mount at top of valve box

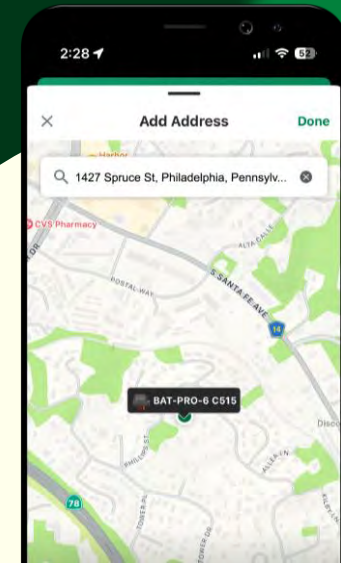

Set map location and name stations

# Testing

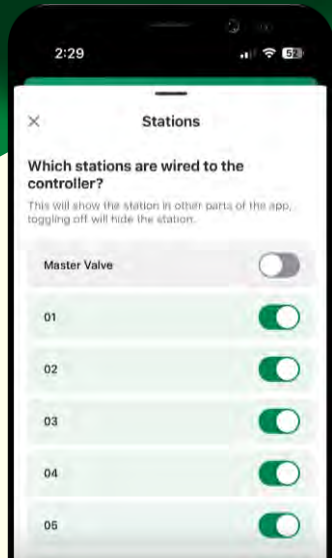

**Station setup to optimize wire diagnostic tools and capabilities**

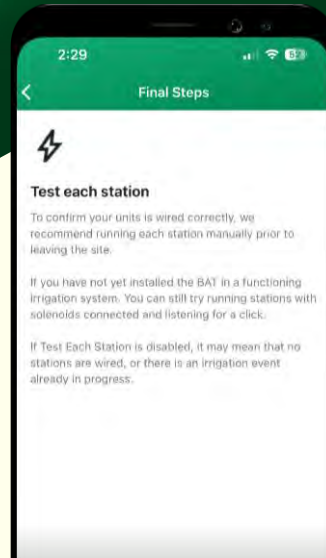

**Run manual tests for each station before leaving site**

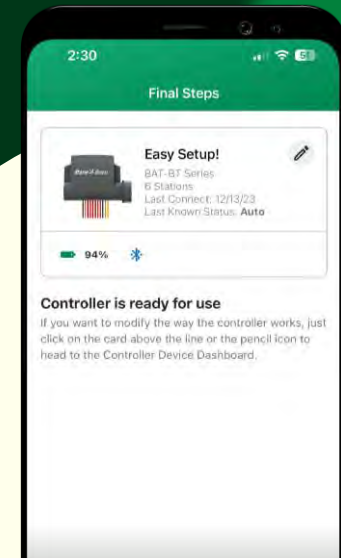

**Setup confirmation**

# Last Known Status

NEW!

Quickly check the status of all controllers from the home screen.

*View at a Glance:*

- **Last Known Status:**
  - **Auto** – Irrigation will run.
  - **Off** – Irrigation won't run.
  - **Rain Delay** – Irrigation is temporarily suspended during a rain event. App keeps track of days remaining and status updates to Auto when the time is up.
  - **Calendar Days Off** – Up to 15 days off a year.
- **Last Connection Date**
- **Battery Level at Last Connection Date**

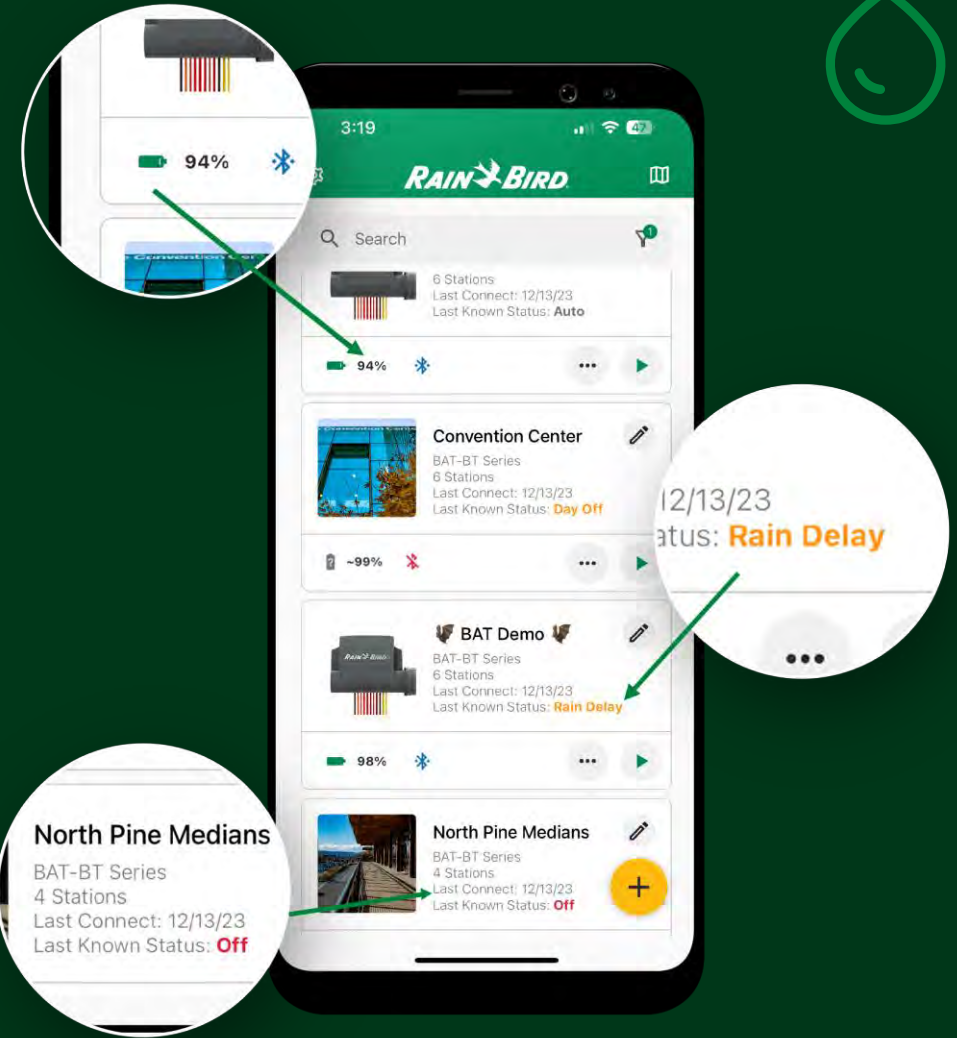

New and Notable

# Quick Indicators

NEW!

**Bluetooth symbol automatically changes states from red to blue once in range.**

Easily identify which controller is closest to you in the field.

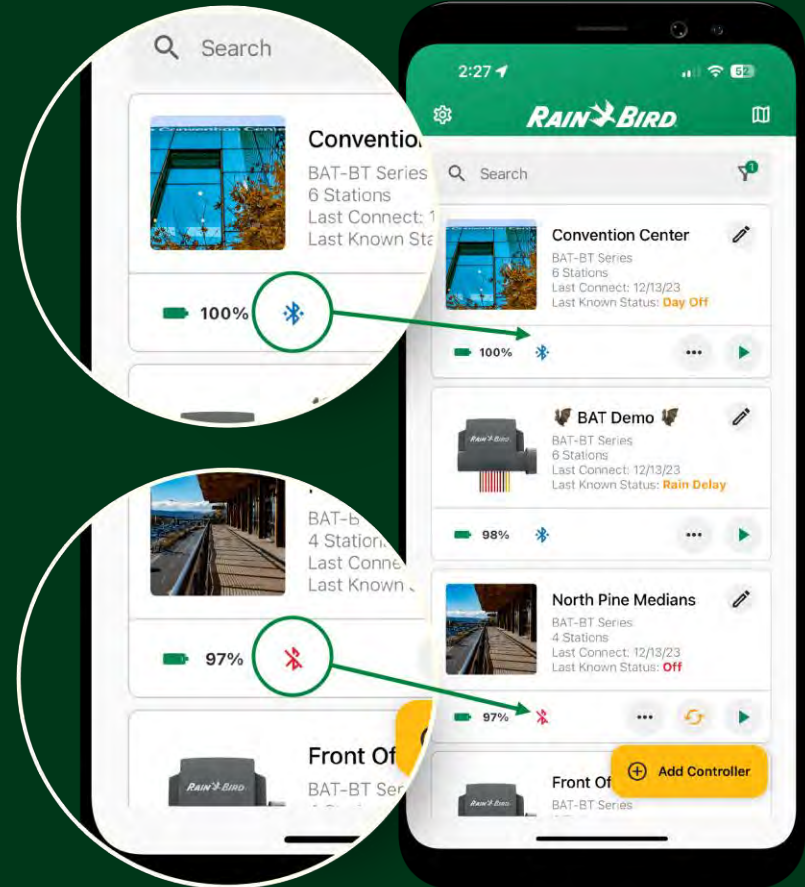

New and Notable

# Search & Filter Functionality

**NEW!** Easily search and filter controllers right from the home screen.

Users can now search for controllers in their portfolio or sort by name, controller type, recently added, or last connected. Filter by Bluetooth in Range, Sync Available, or Low Battery.

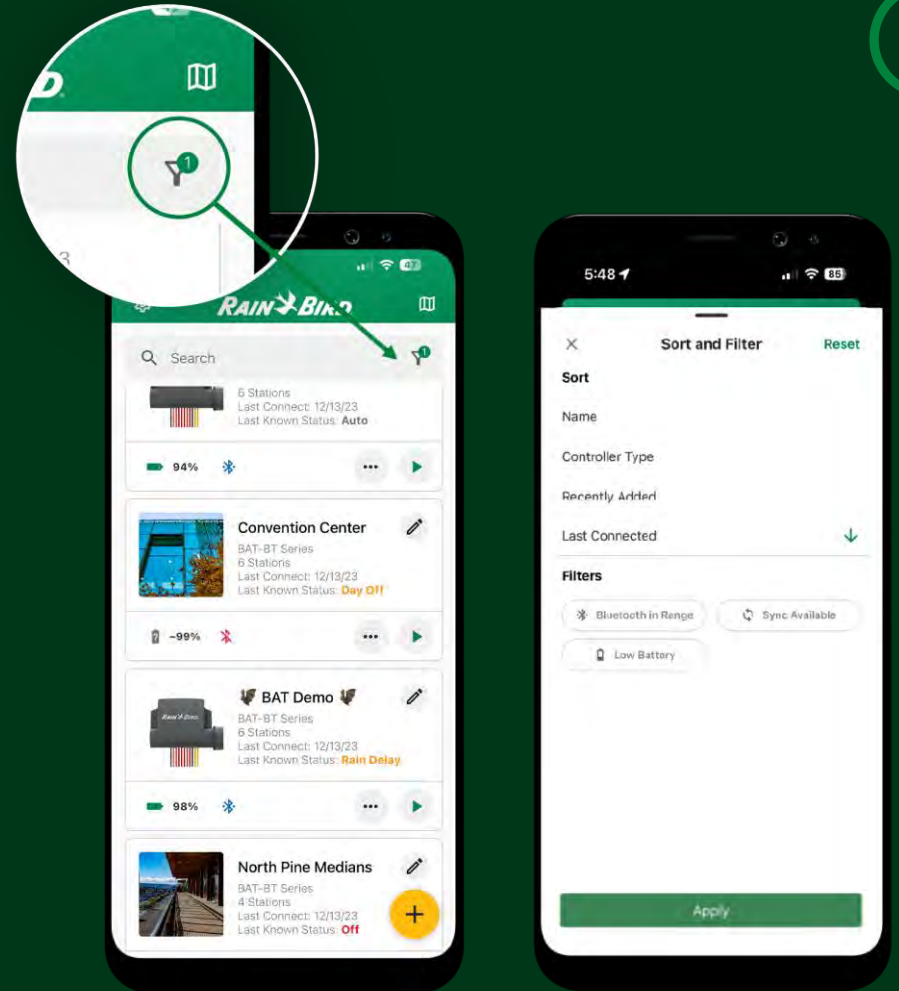



# Advanced Mapping

**NEW!** Industry's best mapping feature.

It's never been easier to select, adjust, and maintain controllers by location.

- Quickly plan your route—controller map pins turn red when battery life is 20% or less.
- When the user selects the pin, the controller card pops up with shortcut option for that controller.
- Satellite or map view.
- List view shows mapped and unmapped devices.

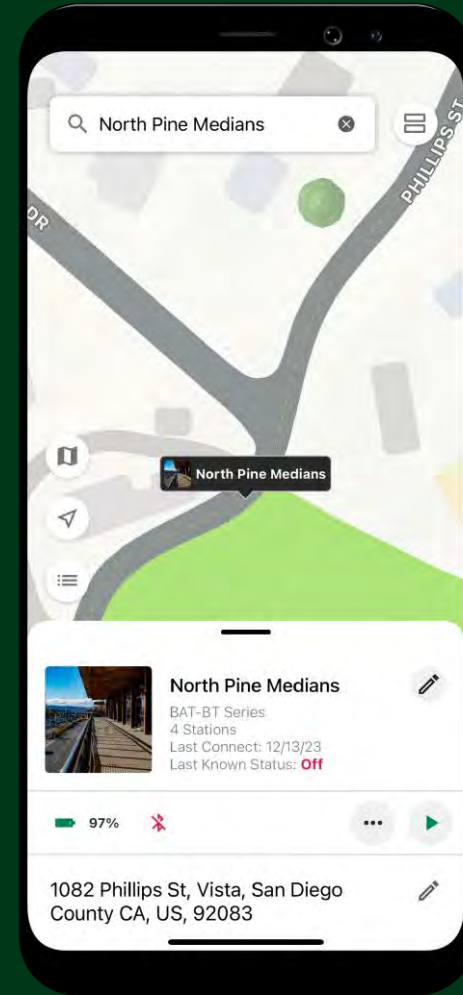

# Offline Mode

**NEW!** Access your device even when you're not connected to Bluetooth.

View and make changes to a schedule at any time.

## *How it Works:*

- Check on the programs and make changes regardless of whether you're connected.
- Once within range again, the app will sync with the controller.
- Share controller card with a co-worker on site, so they can synchronization for you.
- View the change log and either discard changes or “synchronize” to activate the changes.

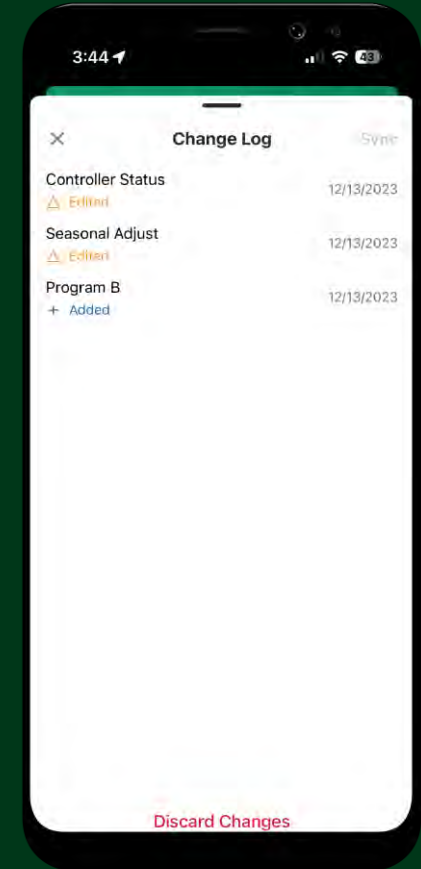
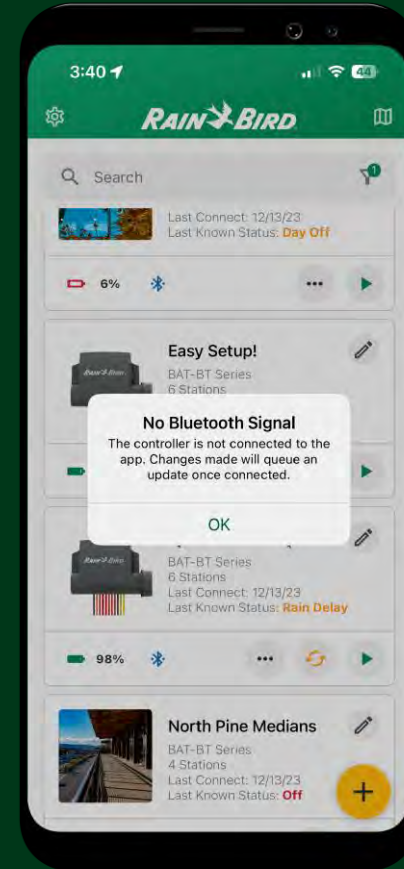

# Controller Sharing

**NEW!** Share controller and controller information with your team.

Share secure access to multiple devices with new team members or keep existing team members up to date. Review logs and accept or deny changes to synchronize between field and office.

## *BAT-BT Shares:*

- Custom Controller Name
- Custom Station Names
- Programs
- Station Setup
- Mapping Pins
- Offline Changes

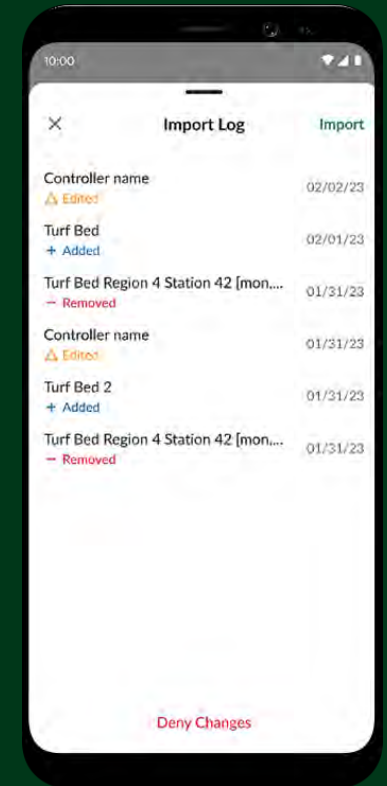
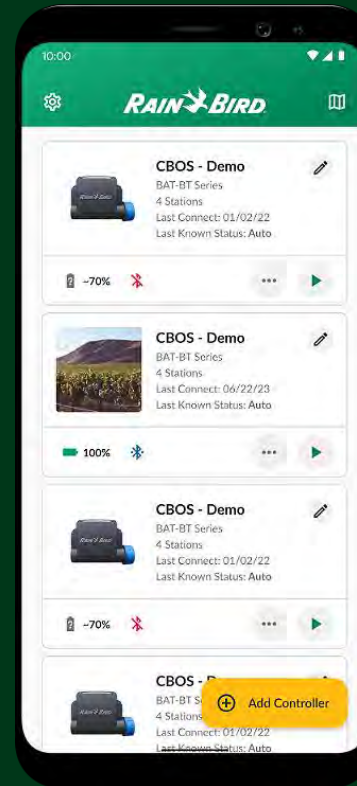

New and Notable

# Monthly Seasonal Adjust

**NEW!** Year-long Monthly Seasonal Adjust (0% to 200%)

Program Monthly Seasonal Adjust values for the entire year in advance. Set Seasonal Adjust values to 0% and the controller will not irrigate for those months, then automatically resume.

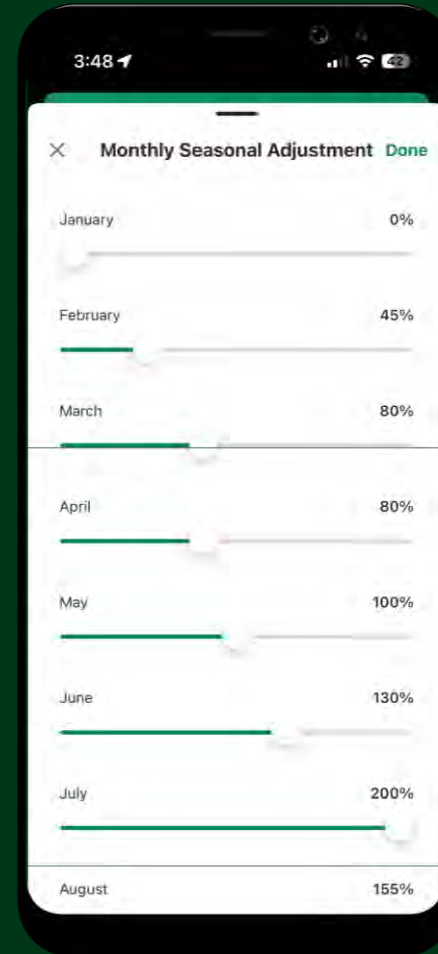

Convenient App Feature

# Rain Delay

**Turn the controller off for up to 14 days and then auto-resume irrigation.**

No need to revisit the site until the rain event is over. If it's forecasted to rain more than 14 days, simply set Monthly Seasonal Adjust values to 0%.

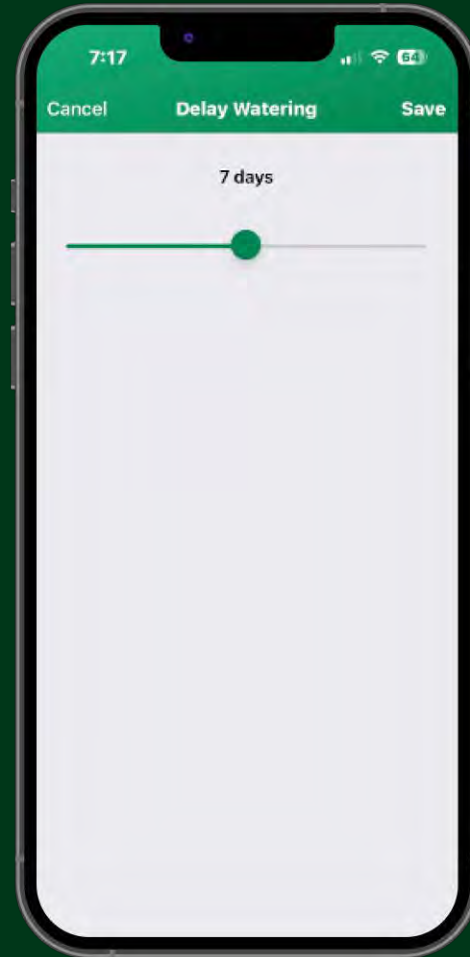

New and Notable

# Calendar Days Off and No-Water Days

NEW!

**Schedule up to 15 days off in advance and exclude certain days of the week.**

Have an event in the park and you want to be sure irrigation doesn't run? Schedule the day off ahead of time. Know that mowing happens every Wednesday? Exclude Wednesdays on a recurring basis.

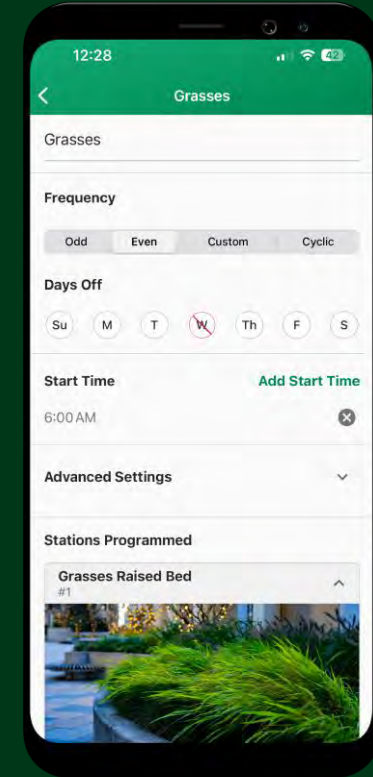

# Manual Water

## Three manual runtime options

- **Quick run:** Runs all stations for the same (user-defined time)
- **Program Run:** Runs user-selected program on demand.
- **Custom Run:** Lets you pick and choose which stations you want to run and for how long.

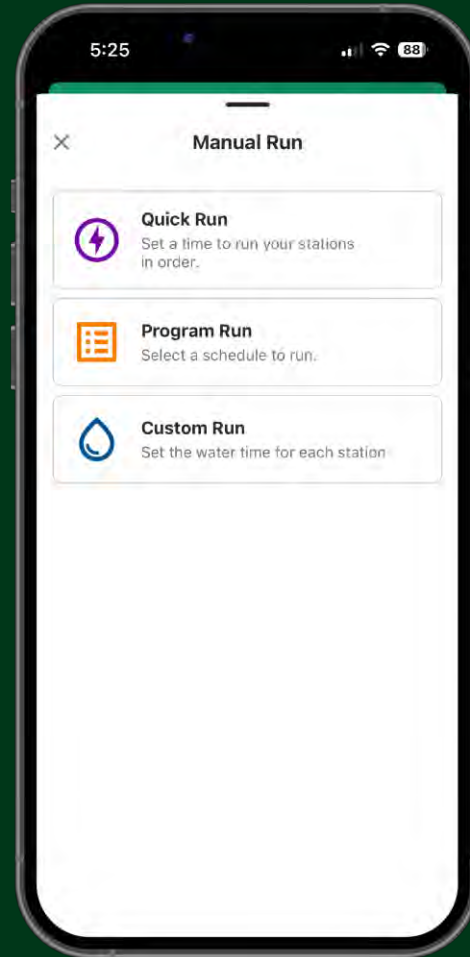

New and Notable

# Manual Water

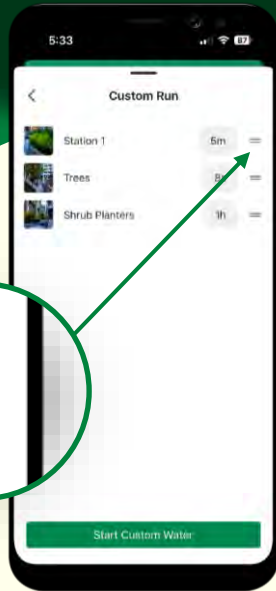

Manually run stations  
in any order you want



See what's running, what's next,  
and pause if necessary

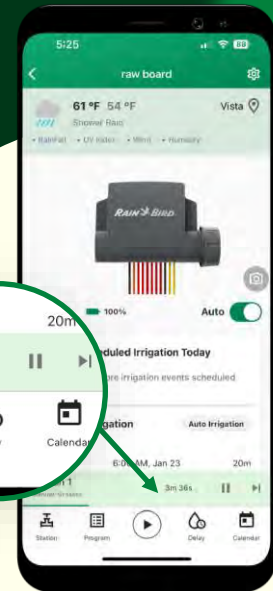

Manual water ribbon with  
quick-access tools



New and Notable

# Station Health and Wire Test

**NEW!** Controller automatically reports on wire health.

Spot issues at a glance with proactive reports on system state.

*The BAT Reports 1 of 3 States:*

- Good Health
- Short Circuit
- Open Circuit

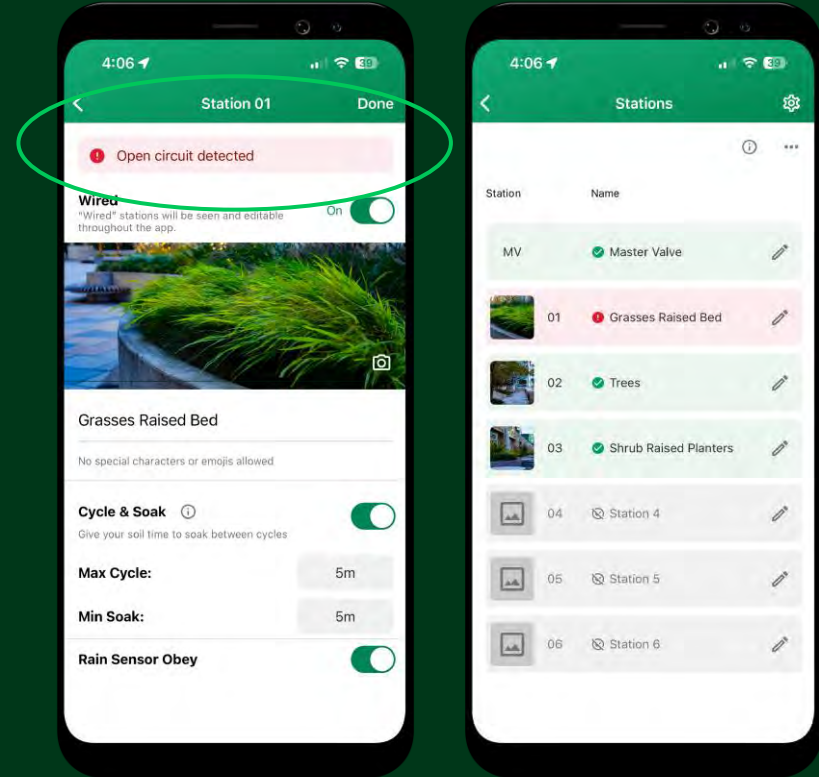

New and Notable

# Additional Image Options

**NEW!** First controller to have custom site and station-level imagery.

Quickly identify stations and sites via custom imagery.

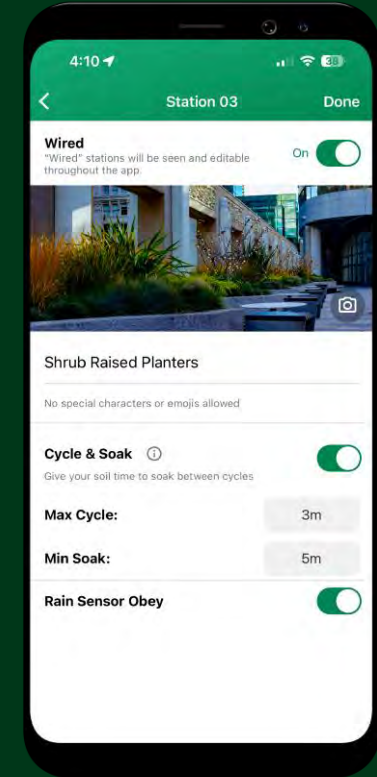
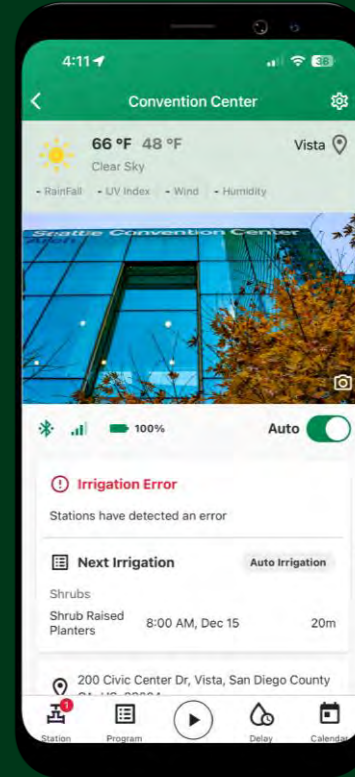

***RAIN***  ***BIRD***®