

Rural Water Solutions

Foot Valves, Check Valves, Pipe Fittings, Quick-Locks, Swivels, Unions & Hose Nozzles



We operate on the foundation of our Mission, Vision, Values, and Core Competencies.

Our Mission

To improve comfort, safety, and quality of life for people around the world through our expertise in a wide range of water technologies.

Our Vision

To be the global leader in providing innovative, high quality products, systems, and solutions for the conveyance, conversation, control, and safe use of water through a focus on customers, innovation, and continuous improvement.

Our Values

1. **Integrity & Respect** - Doing the right thing in the right way, always.
2. **Accountability** - Focusing on results; doing what you say you are going to do.
3. **Continuous Improvement & Innovation** - Maintaining a customer focus; improving every day.
4. **Transparency** - Demonstrating candor and openly sharing information.

Our Core Competencies

We are committed to attracting, developing, and promoting talented people who help create value for our customers and shareholders through their ability and willingness to:

- Collaborate across work groups
- Communicate effectively
- Deliver high-quality work
- Drive for results
- Focus on customers
- Initiate positive change

ANKA is a divisions of Apex Valves. **ANKA** was founded in 1996, designing and establishing a unique range of polythene pipe fittings. The **ANKA** range also extends to Washdown Hose Nozzles, Quick Lock Couplings, Pipe Unions, Swivels, Check Valves and Foot Valves.

Apex Valves specialises in the design and manufacture of float valves for water reservoirs, tanks and troughs. Apex Valves also manufactures water tank accessories such as the VisiBall water level indicator.

In additions to our 'Rural Product Range' Apex Valves manufactures an extensive range of control valves for low and high pressure hot water and filtration systems. We are proud to operate with an ISO 9001 Certified Quality Management System.

Apex Valves is a Watts Water Technologies owned company and has been manufacturing valves for over 35 years. We export to markets in Asia-Pacific, South America, North America, Europe, and Africa. We provide 100% backup and support for all products and are committed to being a progressive, responsible manufacturer, producing high quality, innovative products that are internationally recognised.

www.ankaproducts.com

Contents

PIPE FITTINGS	1
HOSE NOZZLES	4
WASH DOWN / HOSE REEL NOZZLES	5
TRIGGER SPRAY GUNS	7
HOSE TAILS / SERVICE KITS	8
FOOT & CHECK VALVES	9
FEMALE UNIONS	11
AIR VACUUM BREAKERS	11
SWIVELS	12
QUICK-LOCK COUPLINGS	13
WARRANTY	16

Pipe Fittings



AFT FEMALE TEE

15mm	1/2"
20mm	3/4"
25mm	1"
32mm	1 1/4"
40mm	1 1/2"
50mm	2"



AB BEND

15mm	1/2"
20mm	3/4"
25mm	1"
32mm	1 1/4"
40mm	1 1/2"
50mm	2"



ARFC REDUCING FEMALE COUPLING

20 x 15mm	3/4" x 1/2"
25 x 20mm	1" x 3/4"
32 x 25mm	1 1/4" x 1"
40 x 32mm	1 1/2" x 1 1/4"
50 x 40mm	2" x 1 1/2"



AFC FEMALE COUPLING

15mm	1/2"
20mm	3/4"
25mm	1"
32mm	1 1/4"
40mm	1 1/2"
50mm	2"



AFB FEMALE BEND

15mm	1/2"
20mm	3/4"
25mm	1"
32mm	1 1/4"
40mm	1 1/2"
50mm	2"



ARMBL REDUCING MALE BEND (LONG)

15 x 20mm	1/2" x 3/4"
20 x 15mm	3/4" x 1/2"
20 x 25mm	3/4" x 1"
25 x 20mm	1" x 3/4"



AMC MALE COUPLING

15mm	1/2"
20mm	3/4"
25mm	1"
32mm	1 1/4"
40mm	1 1/2"
50mm	2"



AMB MALE BEND

15mm	1/2"
20mm	3/4"
25mm	1"
32mm	1 1/4"
40mm	1 1/2"
50mm	2"



ARFB REDUCING FEMALE BEND

15 x 20mm	1/2" x 3/4"
20 x 15mm	3/4" x 1/2"
25 x 20mm	1" x 3/4"
20 x 25mm	3/4" x 1"
32 x 25mm	1 1/4" x 1"
40 x 32mm	1 1/2" x 1 1/4"
50 x 40mm	2" x 1 1/2"



AMT MALE TEE

15 x 20mm	1/2" x 3/4"
20 x 15mm	3/4" x 1/2"
20 x 20mm	3/4" x 3/4"



AMBL MALE BEND (LONG)

15mm	1/2"
20mm	3/4"
25mm	1"



ARMB REDUCING MALE BEND

15 x 20mm	1/2" x 3/4"
20 x 15mm	3/4" x 1/2"
20 x 25mm	3/4" x 1"
25 x 20mm	1" x 3/4"

Pipe Fittings



AU UNION

20 x 20mm	$\frac{3}{4}'' \times \frac{3}{4}''$
25 x 25mm	1" x 1"
32 x 32mm	1 $\frac{1}{4}''$ x 1 $\frac{1}{4}''$



ABE BRACKET ELBOW

15mm	$\frac{1}{2}''$
15 x 20mm	$\frac{1}{2}'' \times \frac{3}{4}''$
20mm	$\frac{3}{4}''$
20 x 15mm	$\frac{3}{4}'' \times \frac{1}{2}''$
20 x 25mm	$\frac{3}{4}'' \times 1''$



AT TEE

15mm	$\frac{1}{2}''$
20mm	$\frac{3}{4}''$
25mm	1"
32mm	1 $\frac{1}{4}''$
40mm	1 $\frac{1}{2}''$
50mm	2"



ASC STRAIGHT COUPLING

15mm	$\frac{1}{2}''$
20mm	$\frac{3}{4}''$
25mm	1"
32mm	1 $\frac{1}{4}''$
40mm	1 $\frac{1}{2}''$
50mm	2"



ASCL STRAIGHT COUPLING (LONG)

15mm	$\frac{1}{2}''$
20mm	$\frac{3}{4}''$
25mm	1"



AC CONNECTOR

25mm	1"
32mm	1 $\frac{1}{4}''$
40mm	1 $\frac{1}{2}''$



ARC REDUCING COUPLING

20 x 15mm	$\frac{3}{4}'' \times \frac{1}{2}''$
25 x 15mm	1" x $\frac{1}{2}''$
25 x 20mm	1" x $\frac{3}{4}''$
32 x 20mm	1 $\frac{1}{4}''$ x $\frac{3}{4}''$
32 x 25mm	1 $\frac{1}{4}''$ x 1"
40 x 25mm	1 $\frac{1}{2}''$ x 1"
40 x 32mm	1 $\frac{1}{2}''$ x 1 $\frac{1}{4}''$
50 x 40mm	2" x 1 $\frac{1}{2}''$



ARMC REDUCING MALE COUPLING

15 x 20mm	$\frac{1}{2}'' \times \frac{3}{4}''$
20 x 15mm	$\frac{3}{4}'' \times \frac{1}{2}''$
20 x 25mm	$\frac{3}{4}'' \times 1''$
25 x 15mm	1" x $\frac{1}{2}''$
25 x 20mm	1" x $\frac{3}{4}''$
32 x 20mm	1 $\frac{1}{4}''$ x $\frac{3}{4}''$
32 x 25mm	1 $\frac{1}{4}''$ x 1"

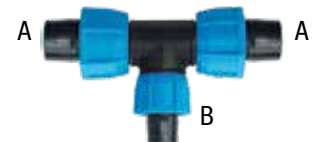

ART REDUCING TEE

15 x 20mm	$\frac{1}{2}'' \times \frac{3}{4}''$
20 x 15mm	$\frac{3}{4}'' \times \frac{1}{2}''$
20 x 25mm	$\frac{3}{4}'' \times 1''$
25 x 15mm	1" x $\frac{1}{2}''$
25 x 20mm	1" x $\frac{3}{4}''$
32 x 20mm	1 $\frac{1}{4}''$ x $\frac{3}{4}''$
32 x 25mm	1 $\frac{1}{4}''$ x 1"
40 x 25mm	1 $\frac{1}{2}''$ x 1"
40 x 32mm	1 $\frac{1}{2}''$ x 1 $\frac{1}{4}''$
50 x 32mm	2" x 1 $\frac{1}{4}''$
50 x 40mm	2" x 1 $\frac{1}{2}''$

KEY: 'A' relates to the first measurement, 'B' relates to the second measurement.

Female Couplings, Bends & Tees

Male Couplings, Bends & Tees

Reducing Couplings, Bends & Tees

Bracket Elbows

Bends

Tees

Straight Couplings

Pipe Fittings

APPLICATION

These strong, non-corrodible and lightweight fittings are suited to a wide range of applications including irrigation, marine, hydroponics, plumbing, agriculture, pumping, hoses, landscaping, and industry.

Designed to fit a large range of N.Z. low density polythene pipes (LDPE), they also work with Australian Rural B, Irish imperial, thin wall lateral pipe and a variety of flexible hoses. Common brands are EnduroFlex2 (Marley), and Alkathene (Iplex).

FEATURES & BENEFITS

- Quick and easy to fit
- Unique **BLUE NUT** is easily visible from a distance
- Non-corrodible, approved for use with drinkable water
- Built tough!

The ANKA Double Barb is a feature of the 25mm - 50mm fittings. The double barb gives a large surface area for the pipe to grip onto.

SPECIFICATIONS

Material: Glass Fibre Reinforced Nylon

Working Pressure: 1600kpa (230psi) @ 20°C (68°F)

Temperature Range: 1°C - 60°C (34°F - 140°F)

INSTALLATION

- Can be fitted to cold pipe in most situations
- Heating the pipe or softening with hot water will help installation
- Use thread tape or thread sealant on all threads, we recommend Loctite 5331
- Simply push the pipe over the barbs up to the "stop", tighten the **BLUE NUT** by hand, then tighten 1-2 turns with a wrench.

CONNECTING TO POLY-PIPE



- 1** Cut & clean pipe, then slide nut away from pipe stop.



- 2** Push pipe over the barbed fitting tail until it touches the pipe stop – **IMPORTANT**



- 3** Hand tighten the Easy Grip nut, then moderately tighten with a wrench.

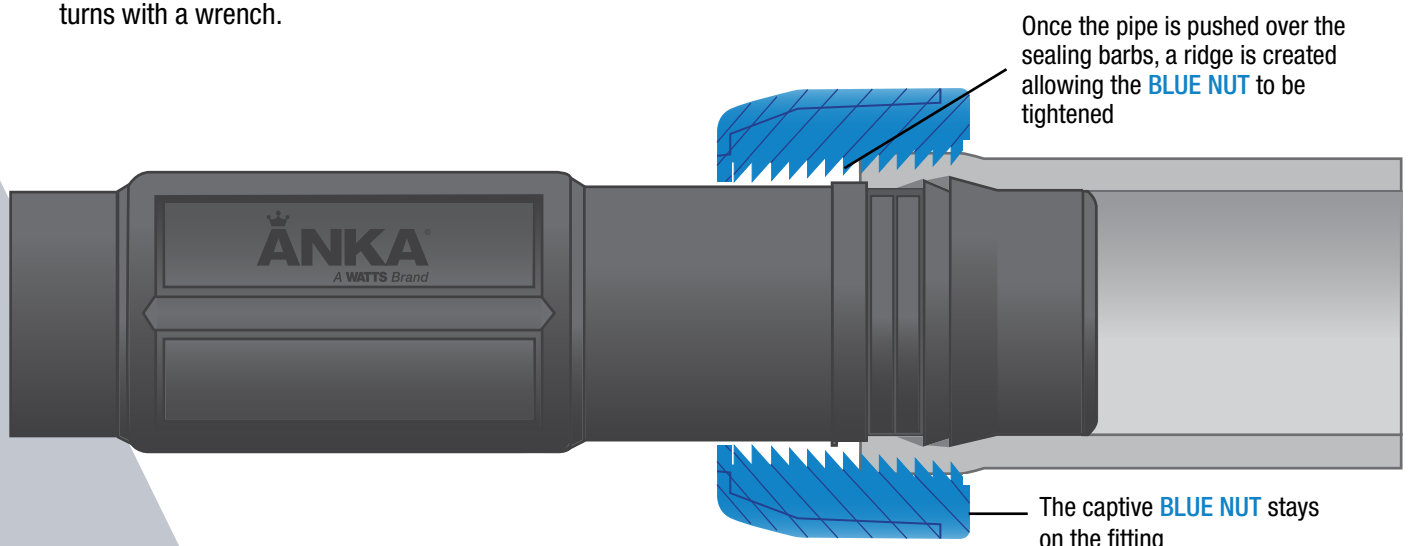

Hose Nozzles

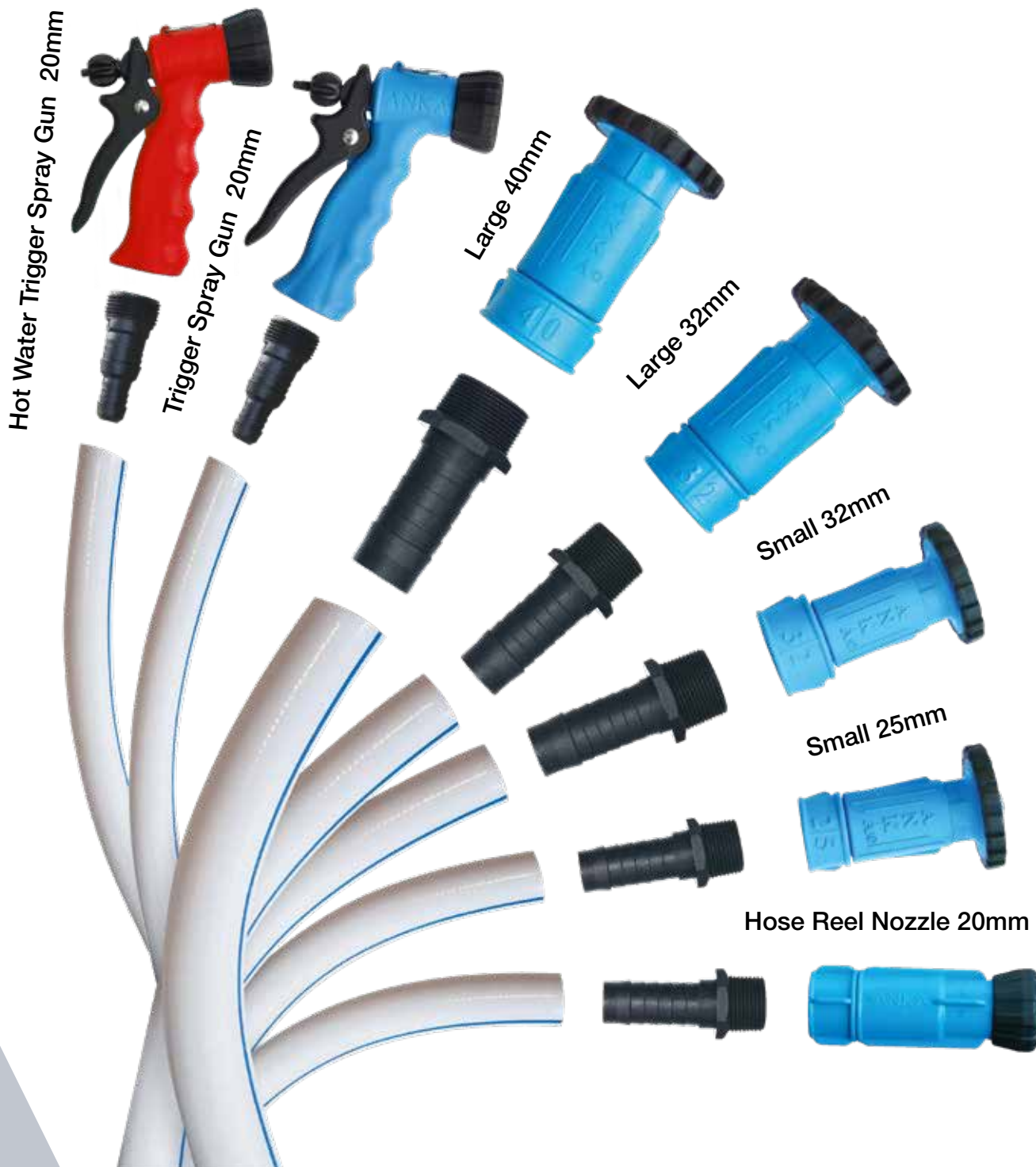

Washdown Nozzles

APPLICATION

Proven to be the best in their class, these compact and reliable nozzles can provide the performance that is required for a quick clean up, in any situation. The large bore nozzles were specifically designed for quick and efficient dairy washdown. For smaller volume washdown, the small bore nozzles are ideal. Agricultural, horticultural, industrial, marine and domestic users can all benefit from this quality range.

FEATURES & BENEFITS

- Protective outer rubber ring
- High flow rates
- Durable
- Quick action on/off
- Adjustable spray pattern
- Non-corrodible high-quality materials
- Serviceable

SPECIFICATIONS

Materials: Glass Fibre Reinforced Nylon body

Temperature Range: Cold water applications

AVAILABLE SIZES

- 25mm (1") Small
- 32mm (1¼") Small
- 32mm (1¼") Large
- 40mm (1½") Large

SPARES & ACCESSORIES

- Hose tails
- Service Kits (for contents see page 8)



40mm Large



32mm Large



32mm Small



25mm Small



Washdown Nozzles

Performance Curve
(Small Hose Nozzles)

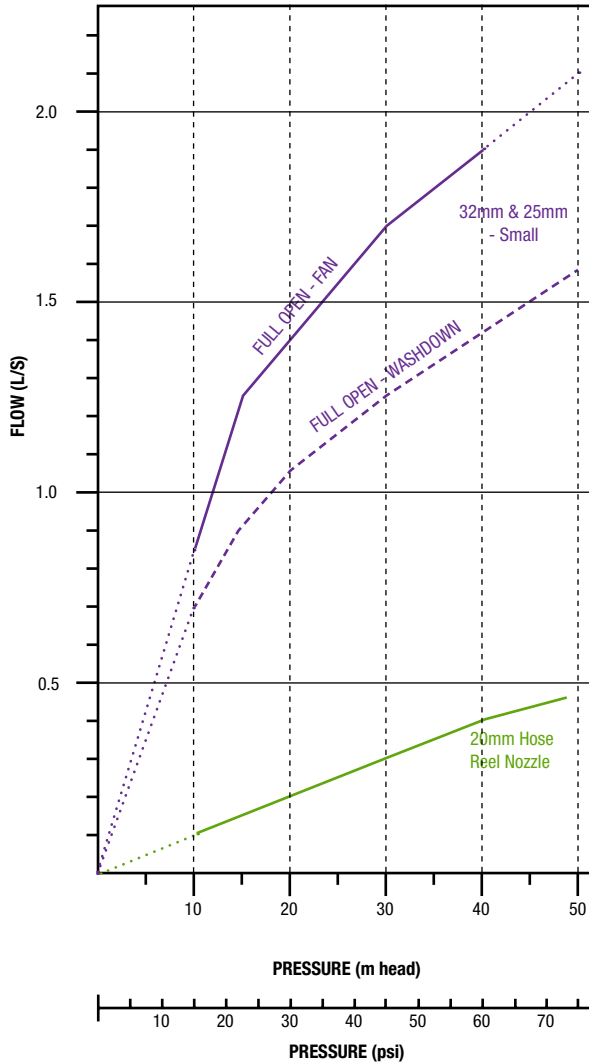

Performance Curve
(Large Hose Nozzles)

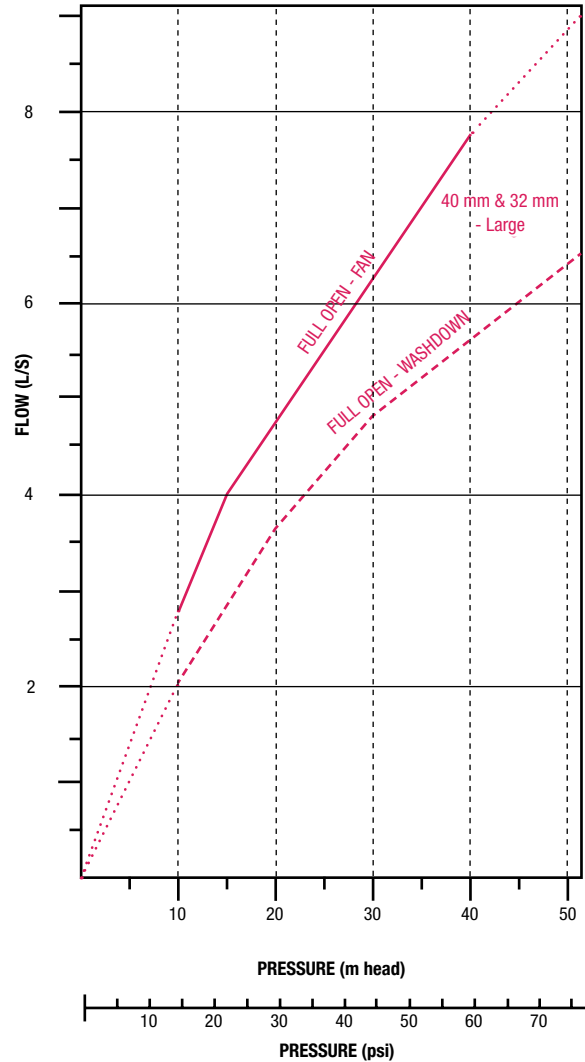

Hose Reel Nozzle

FEATURES & BENEFITS

- Protective outer rubber ring
- Durable
- Quick action on/off
- Adjustable spray pattern
- Non-corrodible high-quality materials

AVAILABLE SIZES

- 20mm (3/4")

SPARES & ACCESSORIES

- Hose Tail
- Snap-on adapter



Trigger Spray Gun

APPLICATION

The Trigger Spray Guns have been designed with the same features that the larger range gives, and have a wide variety of uses.

FEATURES & BENEFITS

- Protective non-marking outer rubber ring
- Durable
- Quick action on/off
- Adjustable spray pattern
- Non-corrodible high-quality materials
- Serviceable

SPECIFICATIONS

Materials: Glass Fibre Reinforced Nylon body

Temperature Range: Cold water applications

Note: The Hot Water Trigger Spray Gun is recommended for temperatures above 60°C. At temperatures above 60°C a heat-safe connection such as an ANKA Hose Tail or ANKA Male Coupling must be used.

AVAILABLE SIZES

- 20mm ($\frac{3}{4}$ ")
- 20mm ($\frac{3}{4}$ ") Hot Water

SPARES & ACCESSORIES

- Hose tails
- Snap-on adapter (*Not to be used with hot water*)
- Service Kits (for contents see page 8)



Trigger Spray Gun



Hot Water Trigger Spray Gun

Hose Tails

FEATURES & BENEFITS

- Unique barb system has no sharp edges which may cause damage to hoses when clamps are used

AVAILABLE SIZES

Hose Tails

- 15mm (½")
- 20mm (¾")
- 25mm (1")
- 32mm (1¼")
- 40mm (1½")
- 50mm (2")



Reducing Hose Tails

- 25mm (1") thread x 20mm (¾") pipe
- 32mm (1¼") thread x 25mm (1") pipe
- 40mm (1½") thread x 32mm (1¼") pipe
- 20mm (¾") thread x 20/15mm (¾"/½") pipe (Double Reducing)



Snap-on Adapter

- 20mm (¾")

Hose Nozzle Service Kits

APPLICATION

Being a mechanical device, the ANKA hose nozzle may need to be serviced over a period of time. The o-rings may wear and silicone grease may need to be reapplied.

INSTALLATION

By simply removing the top cap and unscrewing the stainless steel bolt, the ANKA hose nozzle comes apart for cleaning or servicing quickly and easily. Detailed instructions can be found on each service kit.

AVAILABLE SIZES

Large Hose Nozzle Service Kit

- Contains o-ring, wiper seal, nut, bolt, diffuser and cap (Suitable for Large 32mm Nozzle & Large 40mm Nozzle)

Small Hose Nozzle Service Kit

- Contains two o-rings, nut, bolt, diffuser and cap (Suitable for Small 32mm Nozzle and Small 25mm Nozzle)

Trigger Spray Gun Service Kit

- Contains washer, spindle assembly and top hat

Hot Water Trigger Spray Gun Service Kit

- Contains Viton washer, spindle assembly with Viton seal, and top hat

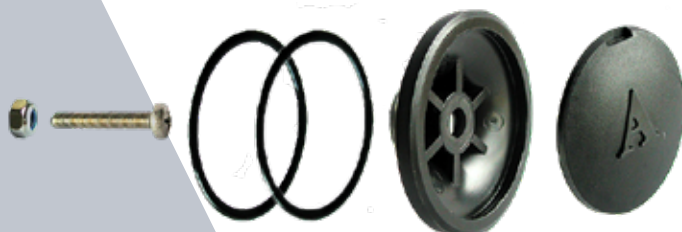

Foot & Check Valves

APPLICATION

ANKA Foot Valves are a spring-loaded non-return valve with a screen which are used at the suction end of pump lines to prevent loss of water and pump prime.

ANKA Check Valves are a spring-loaded non-return valve which can be used in a variety of cold water applications including irrigation, plumbing, marine, domestic, agricultural and industry to allow water to flow in one direction only.

FEATURES & BENEFITS

- Install at any angle
- Durable, versatile and non-corrodible materials
- Can be taken apart for cleaning
- Does not restrict flow
- Spring-loaded

HOW IT WORKS

- Plunger opens fully when pump turns on
- Water flows through valve
- Plunger securely closes & seals

SPECIFICATIONS

Working Pressure: 1600kpa (230psi) @ 20°C (68°F)

Temperature Range: Cold water applications

Threads: BSPT

Materials: Glass Fibre Reinforced Nylon body

316 Stainless Steel spring

Acetyl plunger

Nitrile rubber washer & o-rings

Polypropylene screen (*Foot Valves only*)



Foot Valves



Check Valves

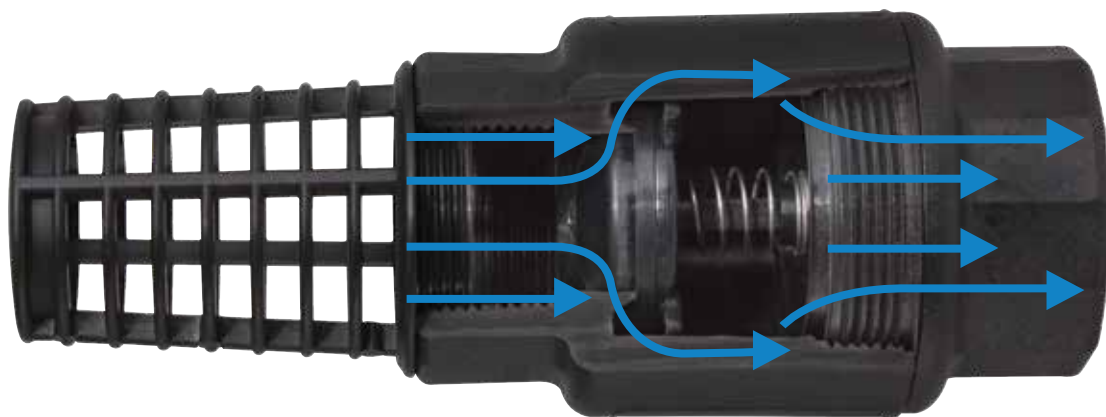

Foot & Check Valves

AVAILABLE SIZES



Foot Valve

- 15mm (½")
- 20mm (¾")
- 25mm (1")
- 32mm (1¼")
- 40mm (1½")
- 50mm (2")



Check Valve

- 15 x 15mm (½" x ½")
- 15 x 15mm (½" x ½") Male x Female
- 20 x 20mm (¾" x ¾")
- 25 x 25mm (1" x 1")
- 32 x 32mm (1¼" x 1¼")
- 40 x 40mm (1½" x 1½")
- 50 x 50mm (2" x 2")

SPARES & ACCESSORIES

- Spare screens



Performance Curve
(Foot & Check Valves)

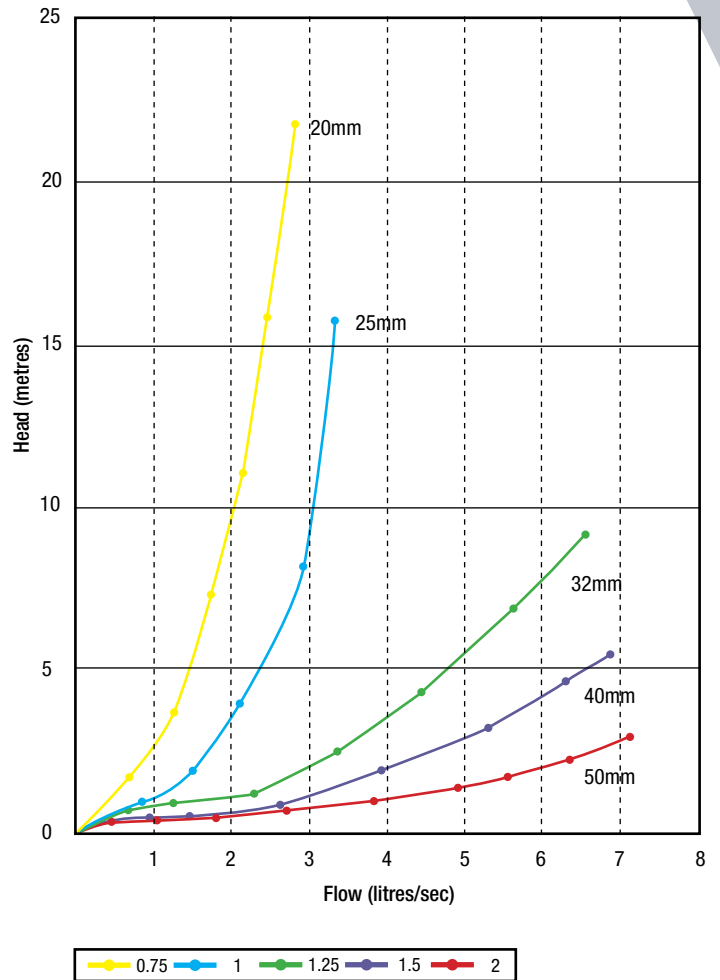

Pipe Unions

APPLICATION

ANKA Pipe Unions are uniquely designed for a number of pipe installations around pumps, tanks, dairysheds, industry and irrigation.

Constructed of high quality industrial glass-fibre reinforced nylon, these unions can be used in place of traditional metal fittings, with the advantage of being non-corrodible.

FEATURES & BENEFITS

- Strong design
- Non-corrodible
- High pressure
- Full Flow

SPECIFICATIONS

Working Pressure: 0 - 1600kpa (0 - 230psi) @ 20°C (68°F)

Material: Glass Fibre Reinforced Nylon

Temperature Range: 1°C - 60°C (34°F - 140°F)

AVAILABLE SIZES

- 20mm (¾")
- 25mm (1")
- 32mm (1¼")
- 40mm (1½")
- 50mm (2")



Air Vacuum Breaker



APPLICATION

The ANKA Vacuum Break Valve will allow air into pipe lines to prevent the pipes from being sucked flat. Once the pressure re-balances, the valve will shut off.

FEATURES & BENEFITS

- Strong design
- One size will suit a wide range of pipe sizes

SPECIFICATIONS

Working Pressure: 0 - 1600kpa (0 - 230psi) @ 20°C (68°F)

Material: Glass Fibre Reinforced Nylon

AVAILABLE SIZES

- 25mm (1")

INSTALLATION

- The valve must be installed in an upright vertical position



Swivels

APPLICATION

ANKA Swivels can be used in low pressure situations to allow a hose pipe to turn 360° without kinking or twisting.

FEATURES & BENEFITS

- Full bore flow
- Strong design
- Non-corrodible

SPECIFICATIONS

Working Pressure: 0 - 482kPa (0 - 70psi)

Material: Glass Fibre Reinforced Nylon

Temperature Range: 1°C - 60°C (34°F - 140°F)

AVAILABLE SIZES

- 20mm (¾")
- 25mm (1")
- 32mm (1¼")
- 40mm (1½")
- 50mm (2")



20mm (¾")



25mm (1")



32mm (1¼")



40mm (1½")



50mm (2")

Quick-Lock Couplings

APPLICATION

Secure coupling designed to be put together and taken apart in one easy twist action.

FEATURES & BENEFITS

- Universal connection to allow for custom combinations
- Easily take piping apart for maintenance or to change lines

SPECIFICATIONS

Working Pressure: 0 - 1000 kPa (0 - 150 psi) @ 20°C (68°F)

Material: Glass Fibre Reinforced Nylon body
Alcryn seal

Threads: BSPT

Temperature Range: 1°C - 60°C (34°F - 140°F)

INSTALLATION

- Ensure seals are lubricated

AVAILABLE SIZES

Female Quick-Lock

- 20mm (¾")
- 25mm (1")
- 32mm (1¼")
- 40mm (2")

Male Quick-Lock

- 20mm (¾")
- 25mm (1")
- 32mm (1¼")
- 40mm (2")



Female Quick-Lock



Male Quick-Lock



Warranty



ANKA warrants each **ANKA** product (“Product”) to the original customer (“Customer”) against defect in materials and workmanship. The term of this warranty is two years from the date of manufacture, plus shipping time. This is a parts only warranty. The Customer is responsible for uninstalling and reinstalling the Product. **ANKA** shall not be responsible nor liable for the cost of field labour or other charges incurred by the customer in removing and/or reinstalling any Product or part thereof.

To make a warranty claim, the Customer should send contact details to **ANKA** at the address below. **ANKA** will contact the customer directly and promptly. If the issue can't be resolved by email or phone discussions, then **ANKA** will decide whether we need to get the product back for testing. **ANKA** may instruct the Customer to send the Product to their point of sale.

The Customer shall bear the freight cost to return the Product to the point of sale. **ANKA** or its authorised agent shall bear the freight cost to ship the Product back to **ANKA** for testing.

This warranty is void in any of the following circumstances:

1. The Product has been misused, mishandled, neglected or abused.
2. The Product is not suitable for the Customer's application.
3. The Product has been improperly installed, operated, repaired, serviced or maintained.
4. The Product has been damaged other than by reason of a Product defect.
5. The Product has been modified.
6. The Product has been connected to other equipment with which it is not compatible.
7. The Product has been used outside its stated specifications, and operating parameters, including specifications and operating parameters relating to capacity, temperature and pressure.
8. The Product has been used for purposes other than which it was designed.

This warranty does not cover damage caused by freezing. It is the responsibility of the customer to please ensure that the product is truly defective under the warranty terms. The Customer should follow the standard trouble shooting procedures. Refer to the technical documentation on the **ANKA** website. If necessary, contact **ANKA** for technical support. This warranty applies to **ANKA** Products only. It does not apply to ancillary equipment over which **ANKA** has no control. Such ancillary equipment includes, without limitation, other plumbing equipment, pipe, hoses and fittings.

Installation is entirely at the Customer's risk. The Customer is responsible for installing the Product in accordance with **ANKA**'s installation instructions and applicable local codes, ordinances and good trade practices. **ANKA** accepts no liability for damages resulting from faulty installation.

ANKA accepts no liability for direct, indirect, incident, special, or consequential damages resulting from the Customer's failure to follow **ANKA**'s warnings, installation instructions and procedures or such other procedures generally applicable to products of the same type. The foregoing limitation extends to damages to person or property as well as the cost of alternative arrangements and the cost of trades people. **ANKA** reserves the right to change or improve its Products or any component thereof without being obligated to provide such a change or improvement for Products sold and/or shipped prior to such change or improvement.

This warranty gives the Customer specific legal rights. The customer may have other rights or remedies pursuant to the laws in its territory. Nothing in this limited warranty should be construed as limiting or restricting any other statutory right or remedy of the Customer, except for such limitations or restrictions herein as may be allowed by the law of the territory. With our policy of continuing product design and development, specifications, code numbers and items are subject to change without notice.

The products in this website are protected by intellectual property rights including patents, registered designs and trademarks owned by Apex Valves Limited. These registrations cover countries including, but not limited to, New Zealand, Australia, USA, Canada, UK, Europe, South Africa and many others.

ANKA and its trademarks belong to Apex Valves Limited.

For full warranty details, please visit www.ankaproducts.com

MANUFACTURER:



367 Rosebank Road, Avondale, New Zealand

Phone: +64 9 828 3123
Toll Free: 0800 500 484

www.ankaproducts.com

*Proudly designed
and manufactured
in New Zealand*

